

K-RERA/PRJ/ERN/179/2024



Prithvi[🌿]
By SIDDHI HOMES
— TRIPUNITHURA —

Prithvi

Our Eternal Connection with Earth

In the ancient lore of Sanskrit, 'Prithvi' holds profound significance. Prithvi, meaning 'Earth,' is not just a planet we inhabit but the essence of life itself. For centuries, our ancestors revered Prithvi as a nurturing mother, a source of sustenance, shelter, and serenity.

Our bond with Prithvi is deep and intrinsic. The earth cradles us in its embrace, providing the resources we need to flourish. It teaches us balance and harmony, urging us to live in tune with the natural world.

As we journey through life, it is easy to forget our roots. But Prithvi gently reminds us of our responsibility to cherish and protect the earth. By honouring Prithvi, we honour ourselves, fostering a sense of belonging and purpose. Prithvi is not just the ground we walk on; it is the heartbeat of our existence, the silent witness to our joys and struggles, and the enduring symbol of life's continuity.

Let us reconnect with Prithvi, embracing the wisdom it offers. In Prithvi, we find not just a home, but a profound sense of peace and belonging.



Prithvi



06

09

03

Siddhi **HOMES**

Transforming Spaces Enhancing Lives

At Siddhi Homes, we believe in crafting not just houses, but homes that embody comfort, elegance, and sustainability. With a commitment to excellence, our projects are designed to harmonize with nature, providing serene and eco-friendly living environments. We pride ourselves on our attention to detail, quality craftsmanship, and dedication to customer satisfaction. Siddhi Homes stands as a testament to innovation and tradition, where modern living meets timeless values. Experience the perfect blend of luxury and tranquillity with Siddhi Homes, where every space is thoughtfully transformed to enhance your life.

Siddhi Homes stands as a testament to innovation and tradition, where modern living meets timeless values. Our designs seamlessly blend contemporary aesthetics with traditional elements, creating spaces that are both stylish and functional. We use the finest materials and sustainable practices to ensure our homes are not only beautiful but also environmentally responsible.

Experience the perfect blend of luxury and tranquillity with Siddhi Homes, where every space is thoughtfully transformed to enhance your life. Join the Siddhi Homes family and discover a new standard of living, where your comfort and happiness are at the heart of everything we do.

 Discover Prithvi

Embracing Nature, Enriching Lives

Welcome to Prithvi, an exclusive project by Siddhi Homes, where the harmony of Earth and modern living converge. Featuring eight luxury villas, Prithvi blends seamlessly with nature, offering tranquillity and sustainability at the forefront. Available in two spacious unit types, these villas provide the perfect blend of luxury and eco-friendly living.

At Prithvi, every detail is thoughtfully designed to create a living space that honours the environment. Our commitment to green living is evident in every aspect, ensuring minimal impact and maximum comfort. Each villa boasts expansive interiors, modern features, and thoughtful designs that maximize natural light and ventilation. Enjoy serene living amidst lush landscapes, where nature's embrace brings you closer to a fulfilling life.

Experience Prithvi with Siddhi Homes, where you can reconnect with nature, and embrace a life of peace and harmony.

Prithvi 
By SIDDHI HOMES



←
ENTRY

PROJECT OVERVIEW

19.06 Ares

Development Size

4.1-4.49 Cents

Plot Area

8

Signature Villas

2300-2600 Sq.ft

Area Range

3&4 BHK

Unit Options





TYPE A

3 BHK

Unit Option

2463 Sq.ft

Super Built up Area

382 Sq.ft

Open Terrace

TWO

Parking



Navigator



GROUND FLOOR



FIRST FLOOR



TERRACE FLOOR

TYPE B

3 BHK

Unit Option

2597

 Sq.ft

Super Built up Area

422

 Sq.ft

Open Terrace

TWO

Parking



Navigator



GROUND FLOOR



FIRST FLOOR

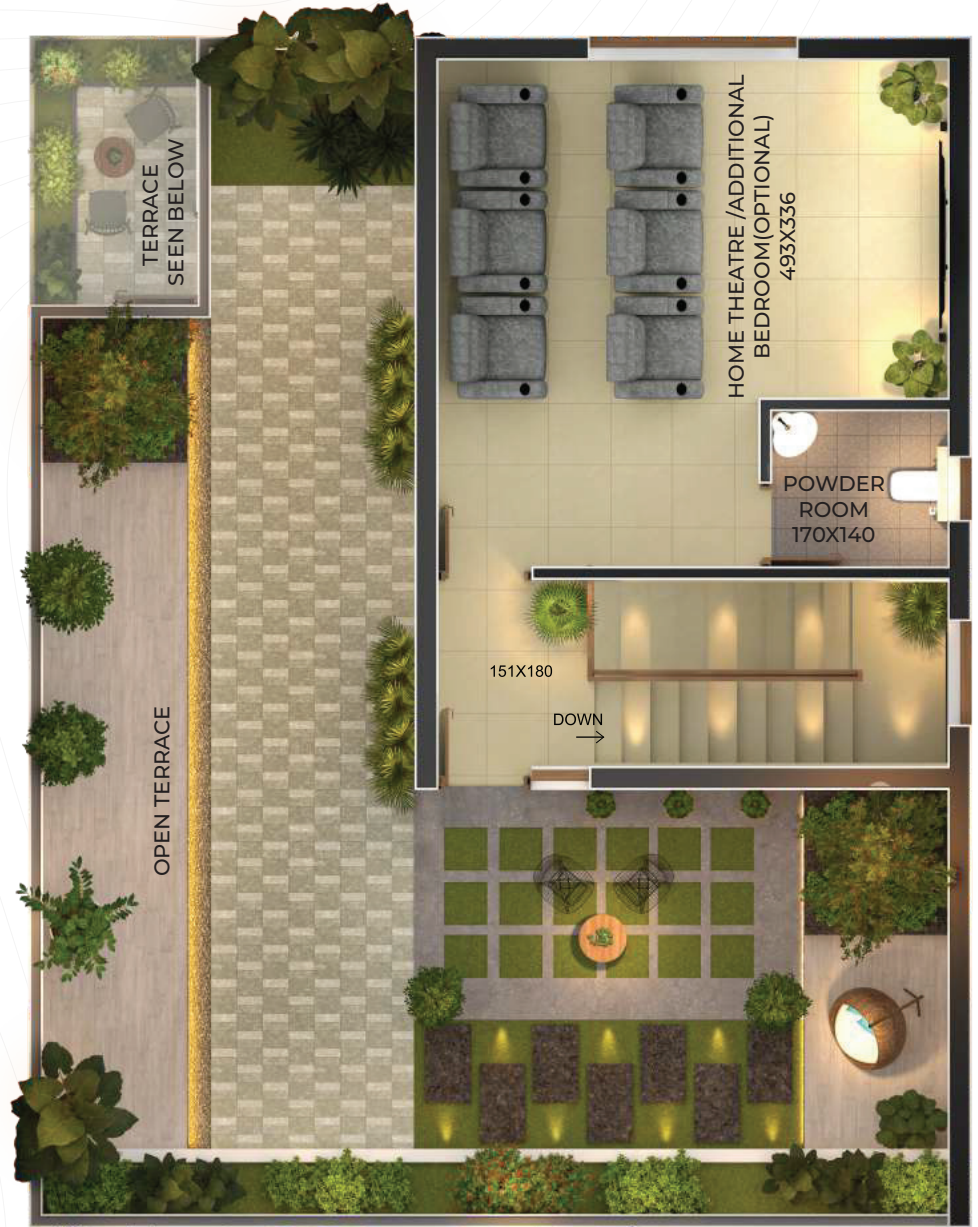

TERRACE FLOOR



SPECIFICATIONS

01 STRUCTURE

- ✓ Raft/ Individual Footing as per structural detailing
- ✓ Load bearing structure using solid blocks/bricks.
- ✓ Concrete grade and steel grade as per structural detailing
- ✓ Internal walls cement plaster with putty and premium emulsion
- ✓ External walls cement plaster and whether shield paint.

02 Electrical

- ✓ Concealed copper wiring. Modular type switches.
- ✓ Generator power back up (1200Watts) for lights, fans, 6 amps plug points except for A/C and Geyser points.
- ✓ Provision for cable TV in living room, M.B.Room.
- ✓ Telephone point and internet connection.

03 DOORS & WINDOWS

- ✓ Decorative paneled main door in teak wood finish with Melamine polish.
- ✓ Branded pre-hung door with engineered door frame for internal doors.
- ✓ Both side laminated flush door with PU coating and PVC wrapped door frame for toilets.
- ✓ Best quality hardware for all doors .
Windows are fully glazed Aluminium windows.

04 SANITARY & PLUMBING

- ✓ Superior quality sanitary ware wall hung EWC with concealed cistern in all toilets.
- ✓ Table top wash basins in dining area (Premium white colored) with concealed cistern.
- ✓ Faucets and CP Fixtures Single lever concealed diverters in all toilets of premium quality.
- ✓ Toughened glass partition to separate the wet area and dry area in toilets.

05 FLOORING

- ✓ Best quality vitrified tiles for living, dining, bedrooms.
- ✓ Kitchen, work area and balcony with rustic finish tiles.
- ✓ Sit out granite/ Anti slip tiles.
- ✓ Toilet tiles upto a height of 7' on toilet walls.
- ✓ Balcony with anti skid tiles.
- ✓ Anti skid tiles on floors and kitchen dado tiles for a height of 2' above the kitchen counter.

06 WATER SUPPLY

- ✓ Provision for KWA water supply subject to rules and regulations of KWA to individual villas.
- ✓ Ground water supply from bore well/open well.
- ✓ All water supply lines shall be in ISI marked ASTM pipes.

07 KITCHEN

- ✓ Kitchen counter with black granite, sink with drain board, sink cock, water purifier provision.



Comprehensive Services for Your Perfect Home

At Siddhi Homes, we believe in offering more than just beautiful homes. Through Siddhi Konnect, we provide a suite of services designed to enhance your living experience. From interiors and maintenance to rentals, our dedicated team is here to ensure your home remains a sanctuary of comfort and convenience.

Interiors

Enhance your home's beauty with Siddhi Konnect's expert interior design services. Our personalized solutions reflect your unique style, making every corner a signature of your preferences. We ensure each space is functional and aesthetically pleasing, embodying luxury and elegance.

Maintenance

Our maintenance services ensure that your home stays in pristine condition. Whether it's routine upkeep or urgent repairs, our skilled professionals are always ready to assist, providing prompt and reliable service to keep your home running smoothly.

Rentals

Navigating the rental market can be challenging, but with Siddhi Konnect, it becomes effortless. Our rental services help you find the perfect tenant or rental property, managing all aspects of the process to make renting a seamless and stress-free experience.

With Siddhi Konnect, you are not just buying a home; you are gaining a trusted partner dedicated to enhancing your lifestyle. Let us take care of the details, so you can focus on enjoying your beautiful home.

Talk to our team:

+91 96456 99000 | customercare@siddhihomes.com

BRAND POOL





Experience the excellence and innovation of the diverse range of premium brands that we use, reflecting the highest quality standards.

Prithvi

By SIDDHI HOMES



Reliance SMART Bazaar 

The Choice School 

Irumpanam Junction



S.N Junction Metro Station 

Vadakkkota Metro Station 

Ettumanoor - Erakulam Road

St. George Jacobite Syrian Cathedral 

Hill Palace Museum 

Tripunithura Railway Station 



Tripunithura Metro Station 

Karingachira

Seaport - Airport Road

Irumpanam - Karingachira Road

Chithrappuzha-Ponjassery Road

Location Highlights

Schools

The Choice School	1.9 Kms
Bhavan's School	2.8 Kms
Georgian Academy	2.5 Kms
Chinmaya Vidyalaya	2.5 Kms

Temples & Churches

Poornathrayeesa Temple	3.8 Kms
Chottanikkara Temple	6.3 Kms
St. George Cathedral	1.7 Kms
Sree Vettikkavu Temple	2.5 Kms

Entertainments

Thanneerchaal Park	0.9 Kms
New Central Talkies	4.3 Kms
Hill Palace Museum	1.9 Kms
Heera Carnival Mall	1.3 Kms
Reliance SMART Bazaar	0.2 Kms

Hospitals

VKM Hospital	2.8 Kms
Varma Hospital	2.9 Kms
RCM Hospital	2.4 Kms
Sunrise Hospital	7.9 Kms

Connectivity

Railway Station	2.6 Kms
Metro Station	3.3 Kms
Water Metro	4.1 Kms
Vytilla Hub	5.8 Kms

Business & IT Hubs

Infopark	5.9 Kms
CSEZ	5.6 Kms
Smart City	8.9 Kms
BPCL	3.7 Kms

Explore the key locations and amenities surrounding Prithvi, ensuring convenience and connectivity.



+91 964 569 9000

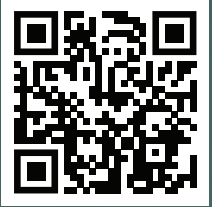

Scan for Walkthrough



 **Siddhi
HOMES**
TRANSFORMING SPACES, ENHANCING LIVES

Corporate Office: 39/141 A1, Ground Floor, Siddhi Sreekala, Near Vadakkekotta Metro Station, Tripunithura, Kochi - 682 301
+91 9645699000 | email: sales@siddhihomes.com | www.siddhihomes.com

Disclaimer: This brochure is conceptual and not a legal offering. All images are for illustrative purposes only. Siddhi Homes reserves the right to change, delete, or add any specifications or plans mentioned herein. Additionally, Siddhi Homes reserves the right to modify the brand pool in the event of non-availability of a particular brand mentioned in the brochure.